

Electrical Specifications

Voltage: 6 VDC
Duty Cycle: Continuous
Resistance: 5.13 ohms \pm 10% (@ 20c)
Amps @ rated Volts: 1.17
Watts @ rated Volts: 7.0
Holding: 140lbs (1/4" Thick 1215 CRS @ 20c)
Operating Temp: -40c to 60c (range)

Additional Components

Screw: N/A
Spring: N/A
Spiral Pin: N/A
Potting: N/A
Rectifier: N/A

Finish: Housing - Zinc or Electroless Nickel Plating
(0.0002-0.0003")

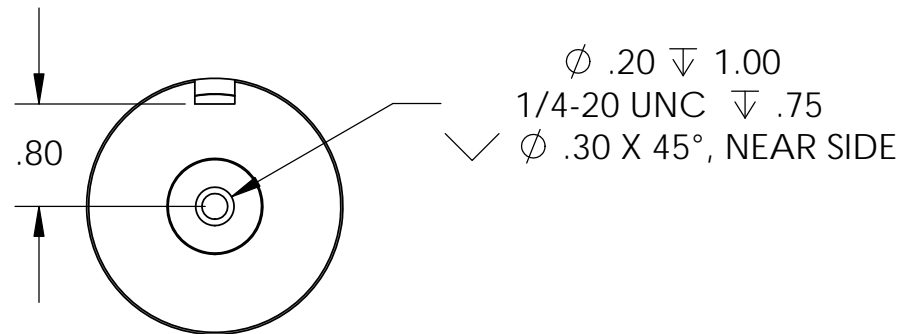

PROPRIETARY AND CONFIDENTIAL
 THE INFORMATION CONTAINED IN THIS DRAWING IS THE SOLE PROPERTY OF APW COMPANY. ANY REPRODUCTION IN PART OR AS A WHOLE WITHOUT THE WRITTEN PERMISSION OF APW COMPANY IS PROHIBITED.

		UNLESS OTHERWISE SPECIFIED:		NAME	DATE	APW COMPANY		
		DIMENSIONS ARE IN INCHES TOLERANCES: FRACTIONAL $\pm .015$ ANGULAR: MACH ± 2 BEND ± 2 TWO PLACE DECIMAL $\pm .005$ THREE PLACE DECIMAL $\pm .003$	DRAWN	K.H.	07.21.11			
		INTERPRET GEOMETRIC TOLERANCING PER: ANSI	CHECKED	J.K.	07.21.11	SIZE	DWG. NO.	REV
		MATERIAL	ENG APPR.	J.K.	07.21.11			
		FINISH	MFG APPR.	J.K.	07.21.11	SCALE: 2:3	WEIGHT:	SHEET 1 OF 1
NEXT ASSY	USED ON		Q.A.					
APPLICATION		DO NOT SCALE DRAWING	COMMENTS:					